



# Industrial Mini-ITX.

The ML400 Series features systems with the balance of industrial design, connectivity and performance that modern businesses demand.

[onlogic.com/ml400-series](http://onlogic.com/ml400-series) >

## High Performance, Solid State Computing

The ML400 Series provides ultra-reliable, high performance computing in a hardened enclosure designed to stand up to rigors of the industrial work space.

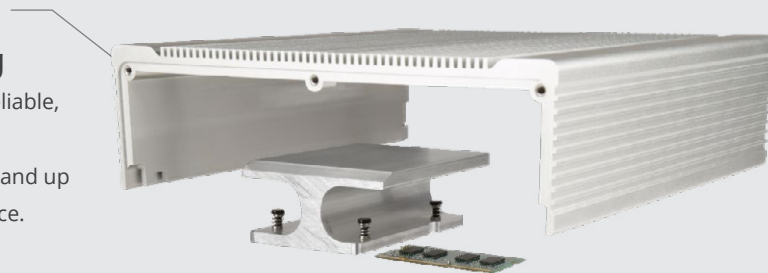

## Maximum Connectivity, Minimum Footprint

With a variety of industrial I/O and the ability to run multiple HD displays, the ML400 Series offers powerful functionality in an extremely compact Mini-ITX form factor.



## Set-It-And-Forget- It Computing

Configured with SSD storage, the ML400 Series is a fully solid state solution that offers exceptional reliability and performance.

### US Office

Phone: +1 802 861 2300  
Email: [info@onlogic.com](mailto:info@onlogic.com)  
[www.onlogic.com](http://www.onlogic.com)

### EU Office

Phone: +31 088 5200 700  
Email: [info@onlogic.eu](mailto:info@onlogic.eu)  
[www.onlogic.com](http://www.onlogic.com)

## Industrial Intel® Bay Trail Celeron® Mini-ITX Computer

Specifications

ML4000G-10

Front I/O	2 USB 2.0 ports Power button	Graphics / GPU	Intel HD Graphics
Rear I/O	1 HDMI port 1 VGA port 2 Gb LAN ports 3 COM ports (RS-232/422/485) 1 COM port (RS-232) 2 USB 3.0 ports 2 USB 2.0 ports 1 PS2 keyboard port 1 PS2 mouse port 2 Audio jacks: line-out, mic-in 1 DC jack	Memory Type	DDR3L SO-DIMM (non-ECC)
Processor	Intel Celeron J1900	Memory Capacity	Up to 8 GB
Processor Speed	2 GHz	Memory Speed	1333 MHz
Processor Generation	Bay Trail	LAN Controller	Realtek RT8111G-CG
Processor Core	4	Input Voltage	9 ~ 19 V
		Power Input	DC jack
		Operating Temp. Range	0°C ~ 50°C
		Dimensions (WxHxD)	196 mm x 57 mm x 202 mm
		Case Material	Steel With Aluminum Extrusion
		Mounting Options	DIN-mount, VESA MIS-D 100 mount, Wall-mount

## Dimensional Drawings

All measurements in mm

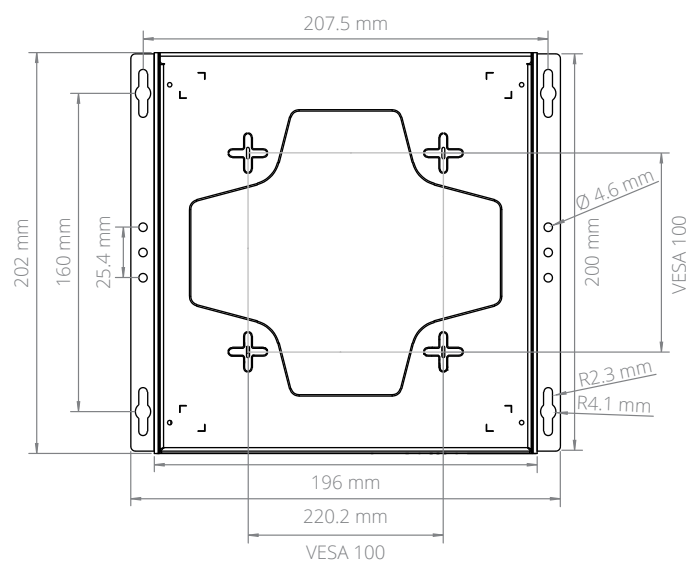

[onlogic.com/ml400g-10](http://onlogic.com/ml400g-10) >

### US Office

Phone: +1 802 861 2300  
Email: [info@onlogic.com](mailto:info@onlogic.com)  
[www.onlogic.com](http://www.onlogic.com)

### EU Office

Phone: +31 088 5200 700  
Email: [info@onlogic.eu](mailto:info@onlogic.eu)  
[www.onlogic.com](http://www.onlogic.com)

## ML400 Dimensional Drawings

Fanless Mini-ITX Case

*All measurements in mm*

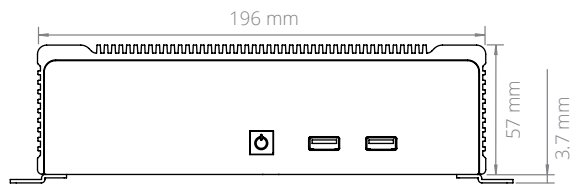

FRONT



SIDE

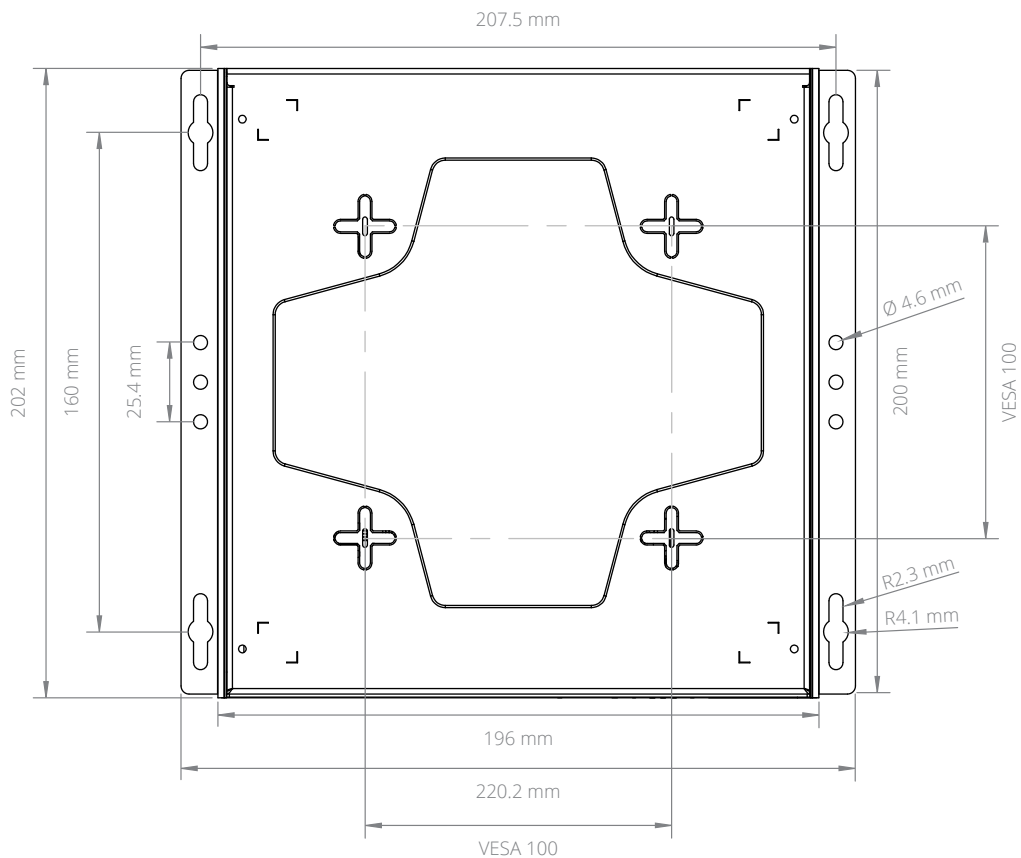

BOTTOM

[onlogic.com/ml400-series](https://onlogic.com/ml400-series) >

**US Office**

Phone: +1 802 861 2300

Email: [info@onlogic.com](mailto:info@onlogic.com)

[www.onlogic.com](http://www.onlogic.com)

**EU Office**

Phone: +31 088 5200 700

Email: [info@onlogic.eu](mailto:info@onlogic.eu)

[www.onlogic.com](http://www.onlogic.com)

## ML400G-10 Backplate Dimensional Drawings

Fanless Mini-ITX Case

*All measurements in mm*

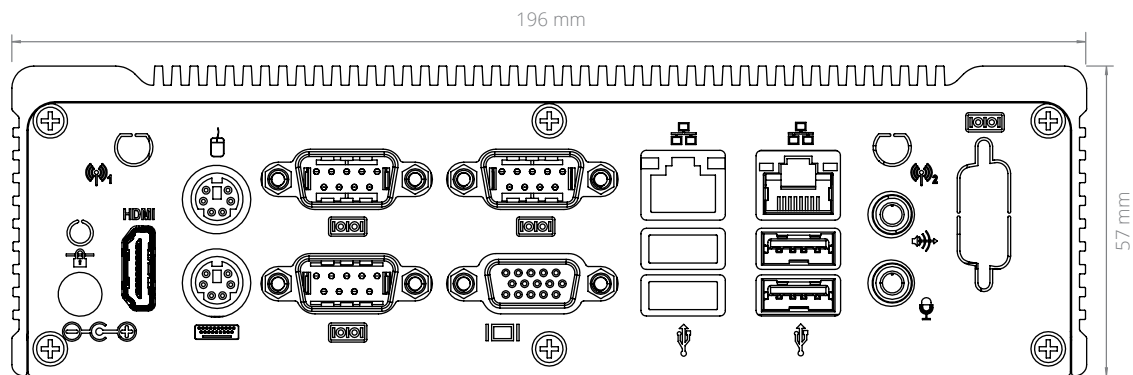

BACK

[onlogic.com/ml400g-10](https://onlogic.com/ml400g-10) >

### US Office

Phone: +1 802 861 2300

Email: [info@onlogic.com](mailto:info@onlogic.com)

[www.onlogic.com](http://www.onlogic.com)

### EU Office

Phone: +31 088 5200 700

Email: [info@onlogic.eu](mailto:info@onlogic.eu)

[www.onlogic.com](http://www.onlogic.com)